

Kommode art. 2003

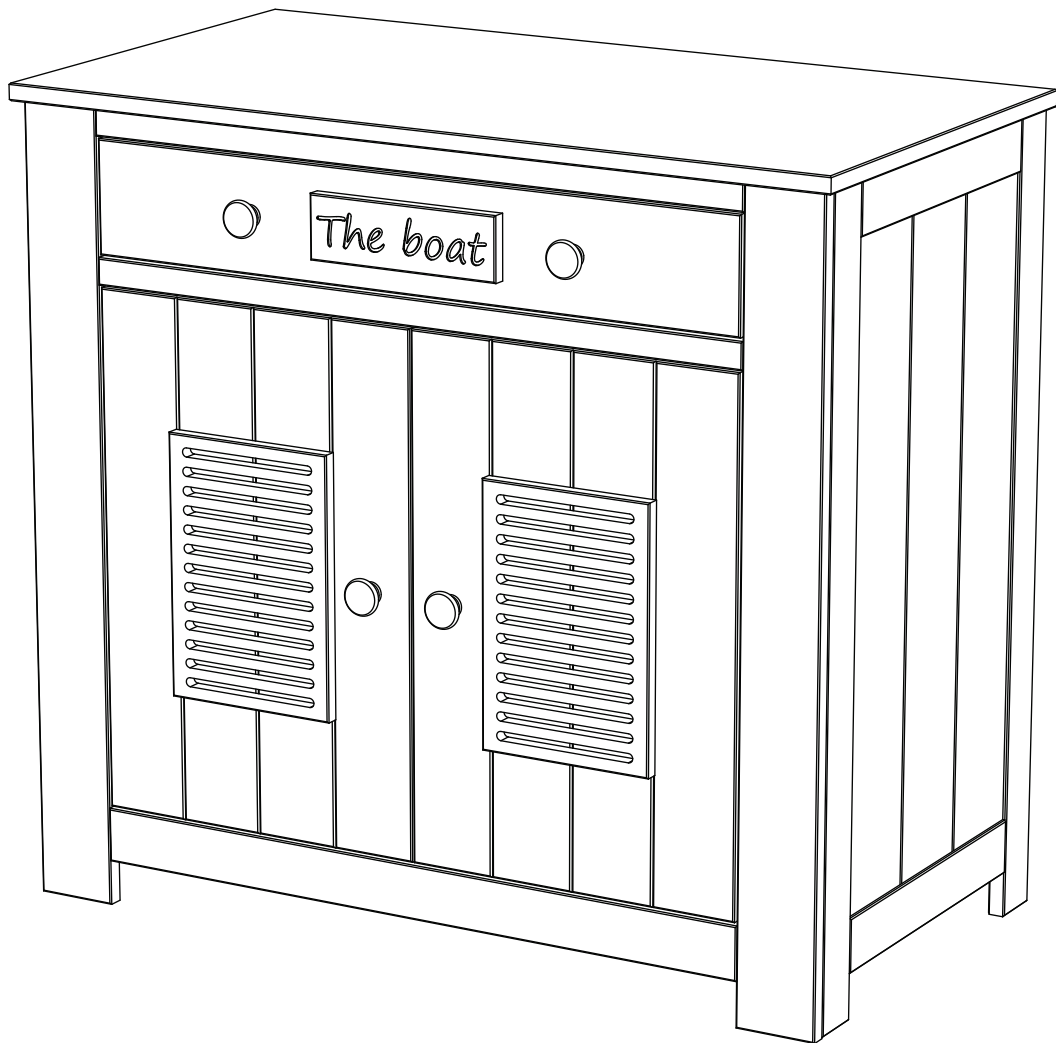

Assembled size / Maße aufgebaut :

Height / Höhe : 899 mm.

Width / Breite : 970 mm.

Depth / Tiefe : 520 mm.

**This unit can be
assembled by two persons.**

Aufbau mit zwei Personen.

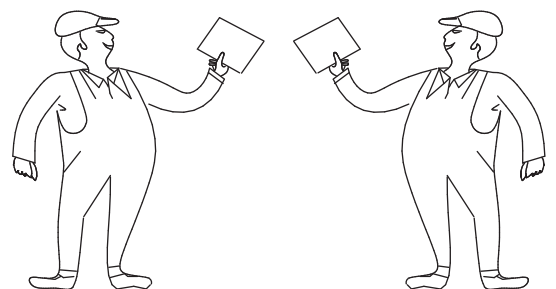

Herzlichen Glückwunsch

Beachten Sie bitte:

**Massiv-Holz ist ein organisches Material und passt sich den jeweiligen Umweltbedingungen an.
Leichter Verzug, Haarrisse und Oberflächendetails sind daher kein Reklamationsgrund,
sondern ein Qualitätsmerkmal des Materials.**

**The necessary tools
(not included)**

**Die dazu benötigten Werkzeuge
(ausschliesslich)**

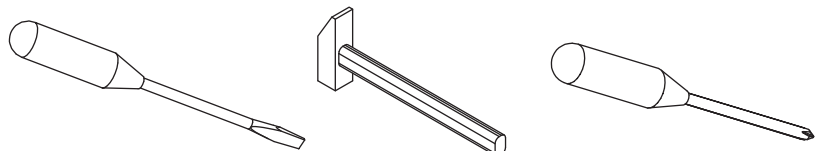

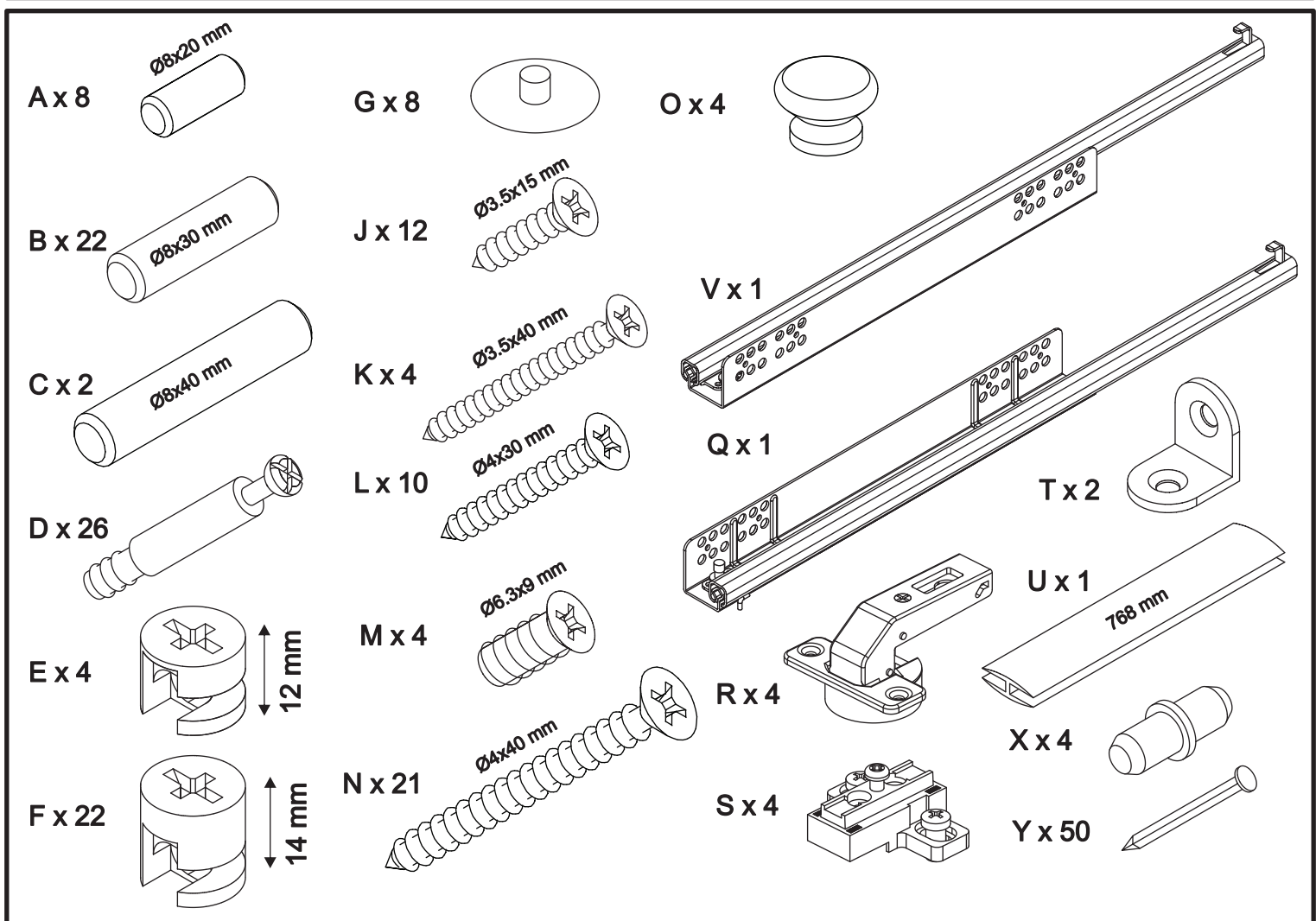
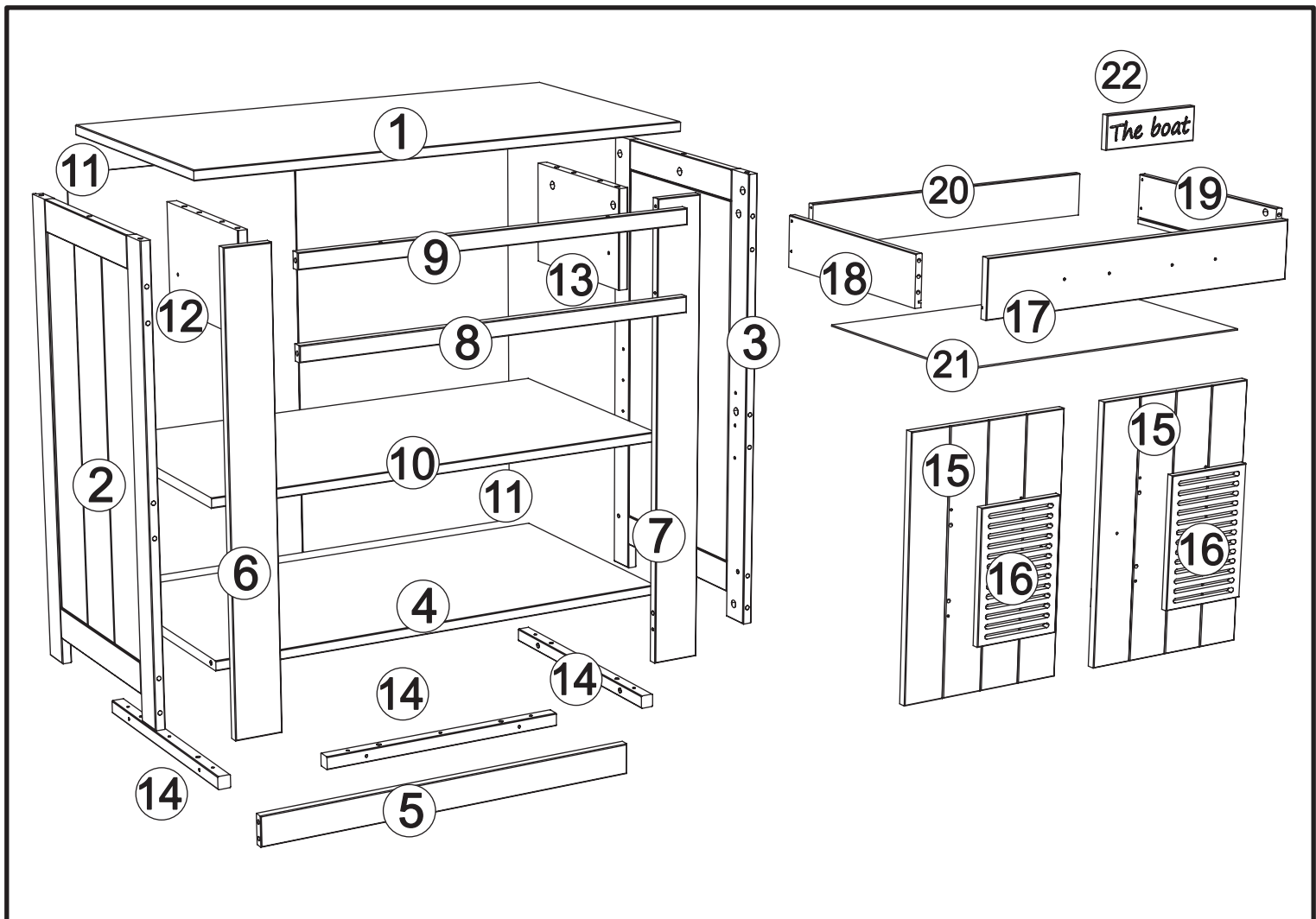

1

B x 20

C x 2

F x 22

14 mm

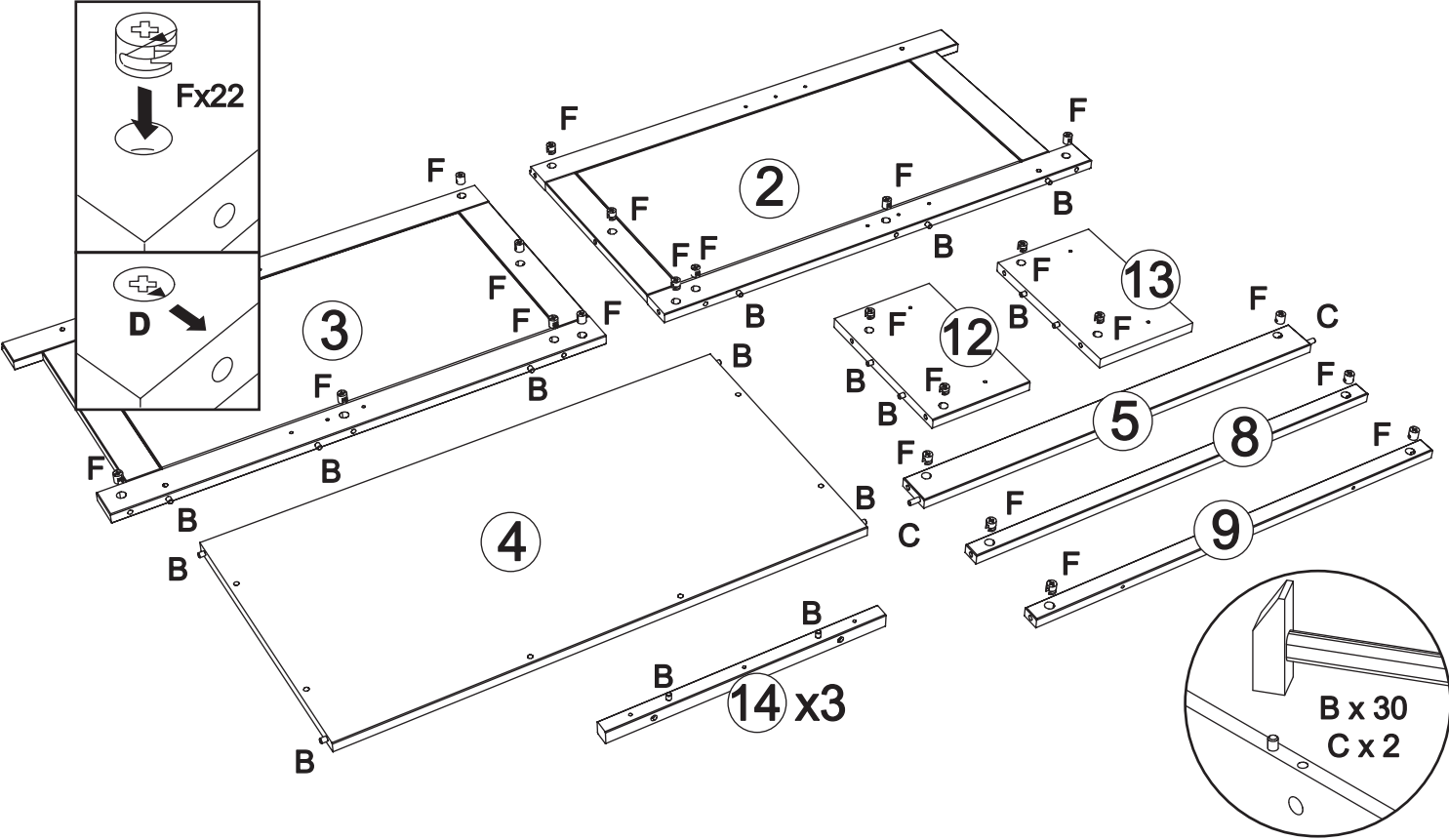

2

N x 9

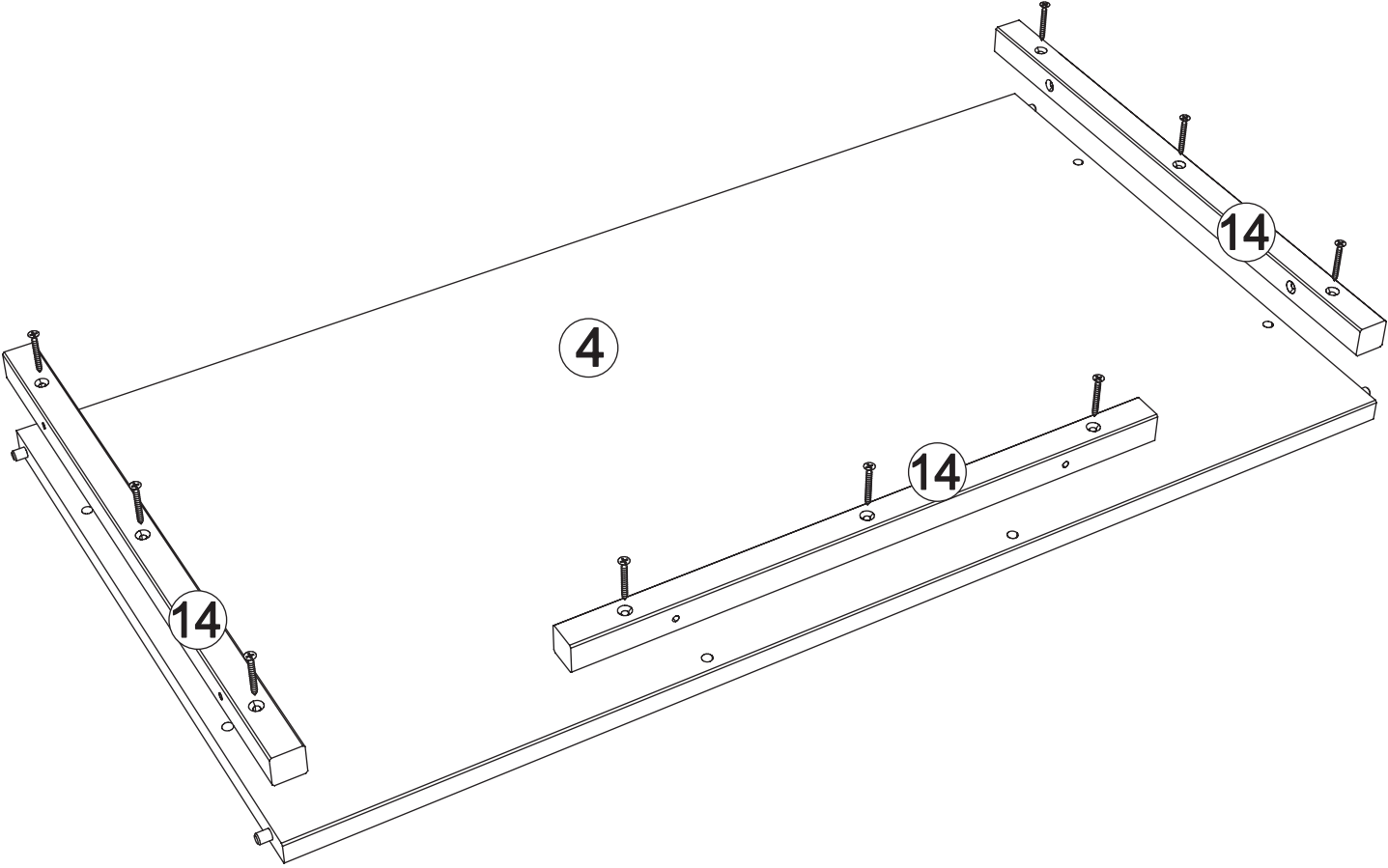

3

D x 22

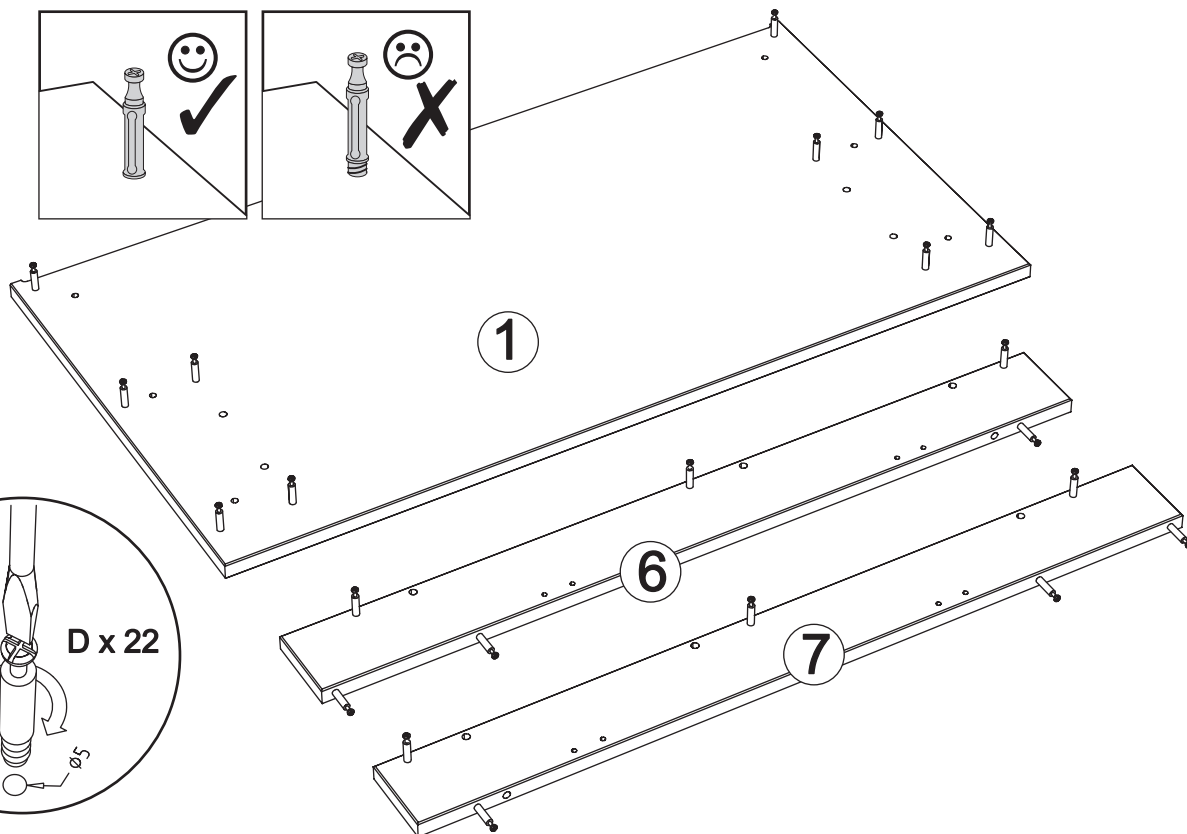
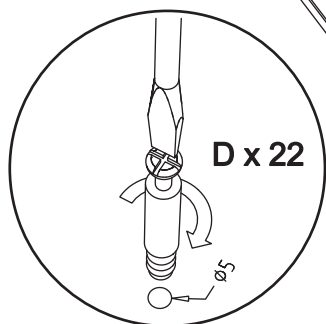
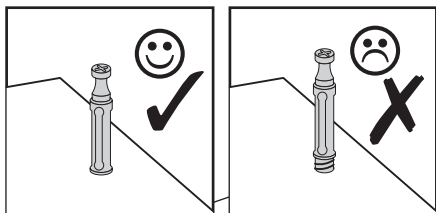
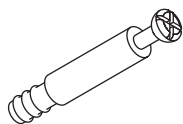

4

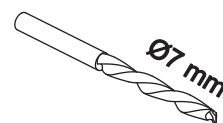

Wenn Sie Haben Wickeltisch art.2004

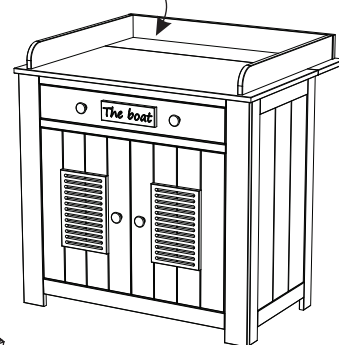
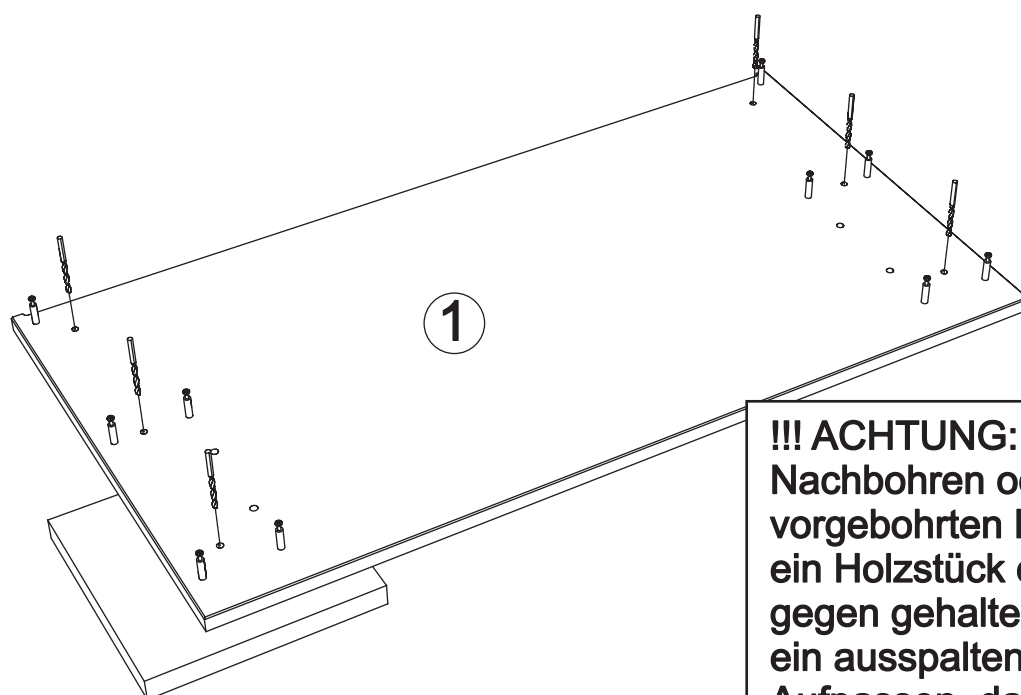

!!! ACHTUNG:
Nachbohren oder durchstechen der vorgebohrten Löcher von vorne ein Holzstück oder ähnliches gegen gehalten wird. Damit ein ausspalten verhindert wird. Aufpassen, dass die richtigen Löcher verwendet werden.

5

S x 4

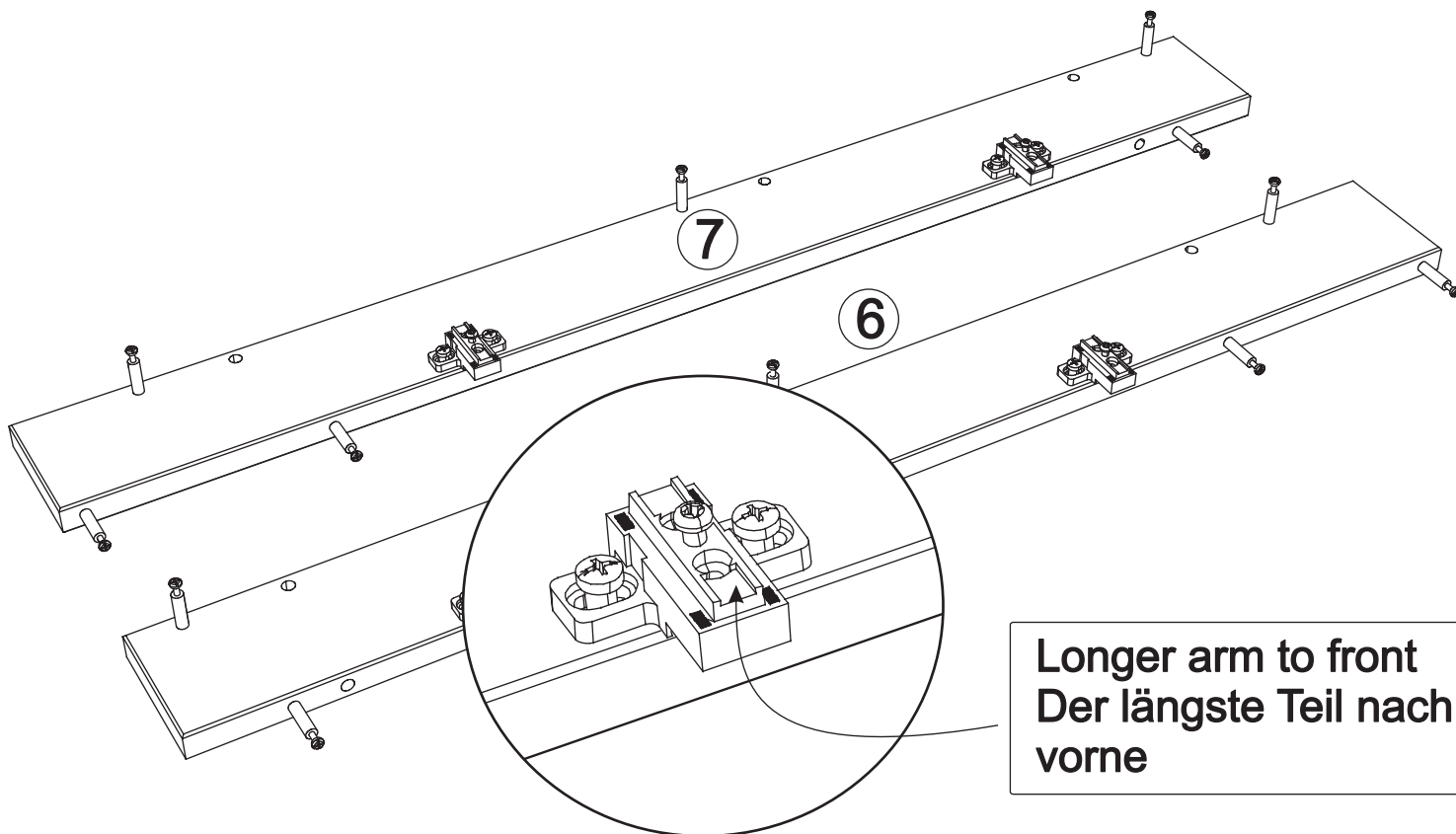
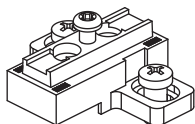

6

G x 4

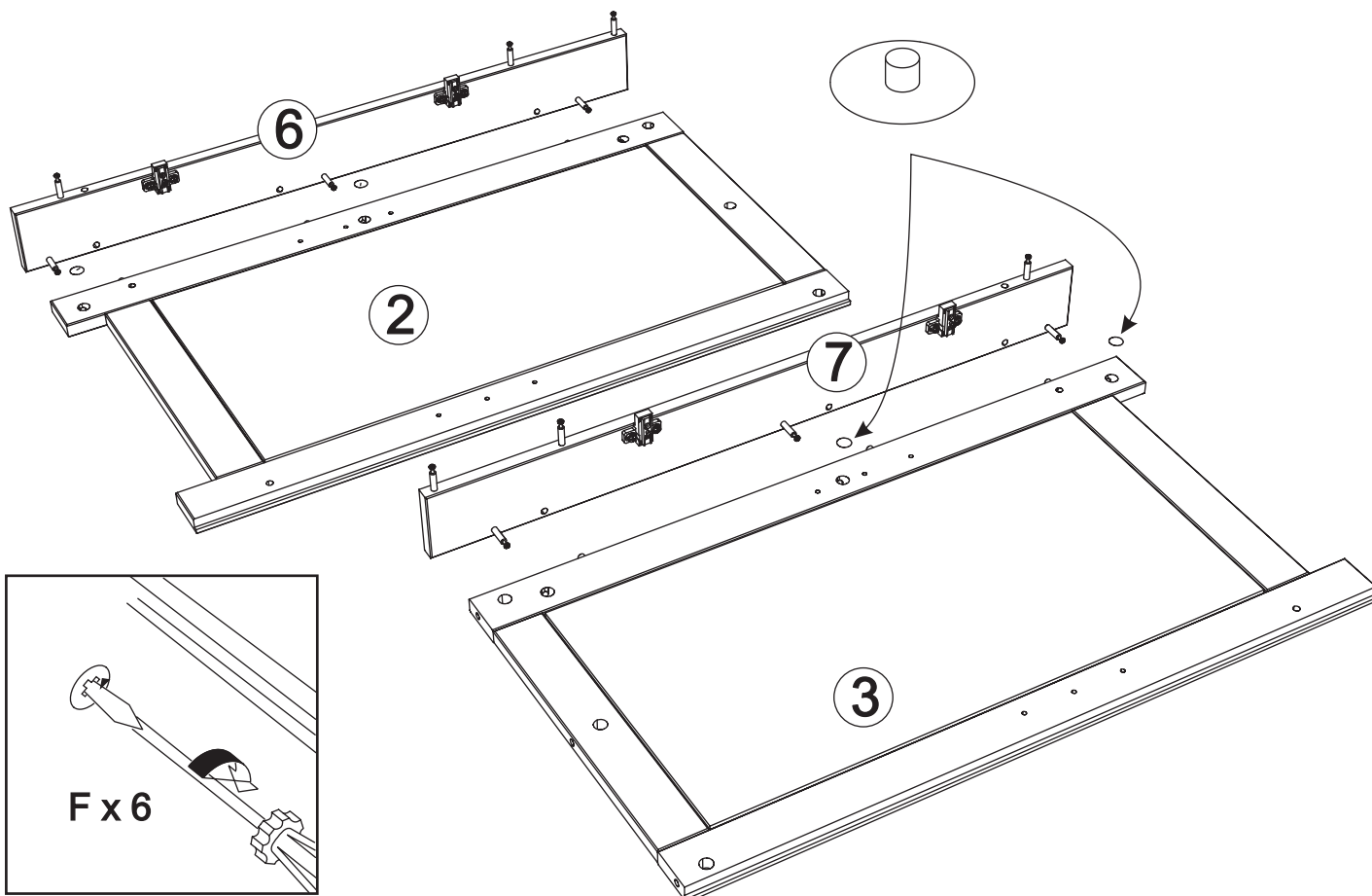
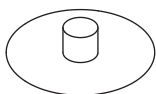

7

N x 6

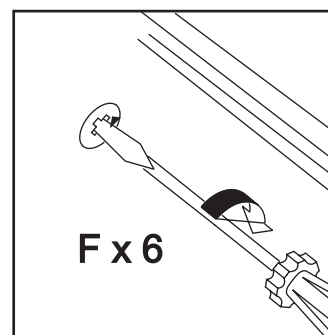
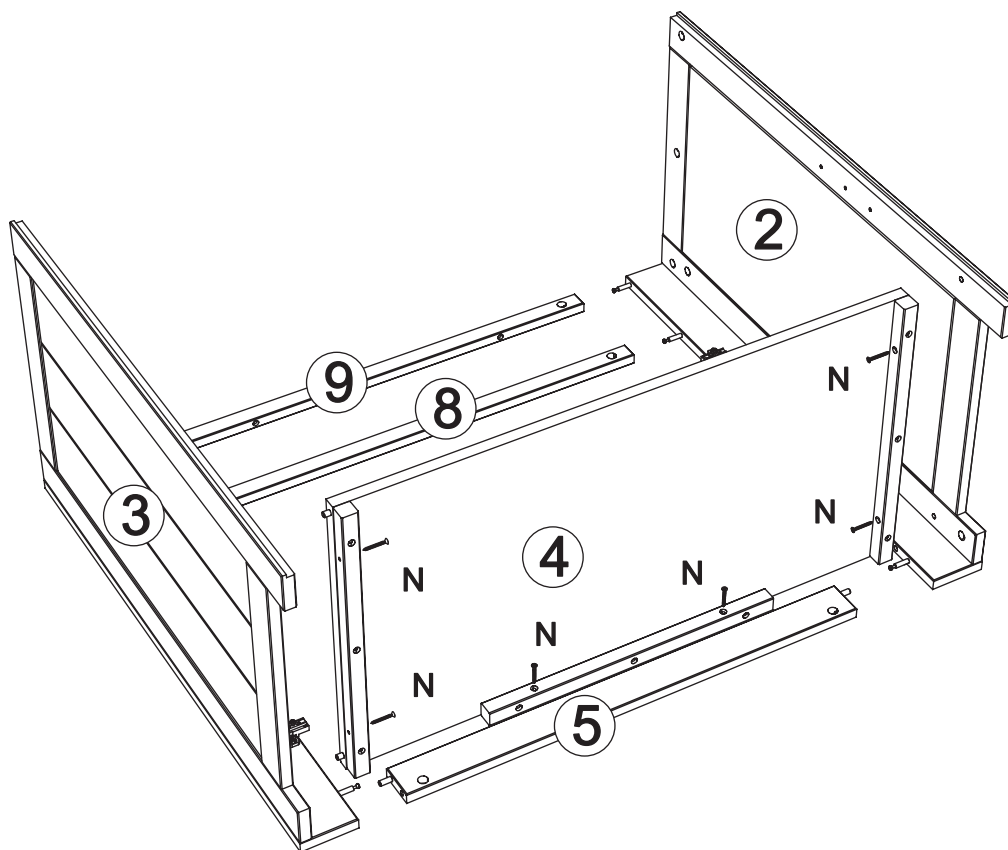
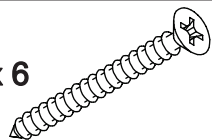

8

N x 2

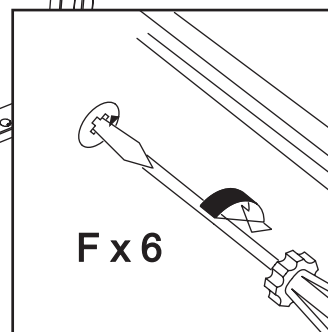
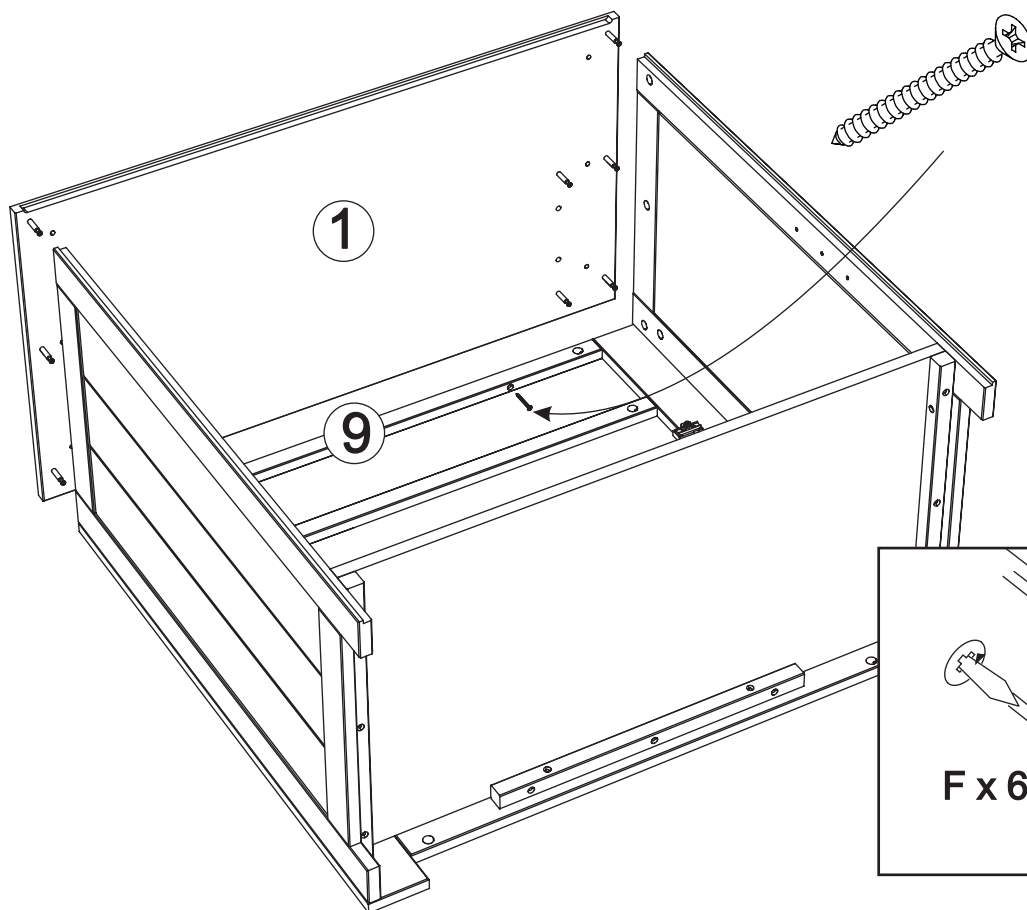
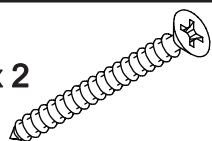

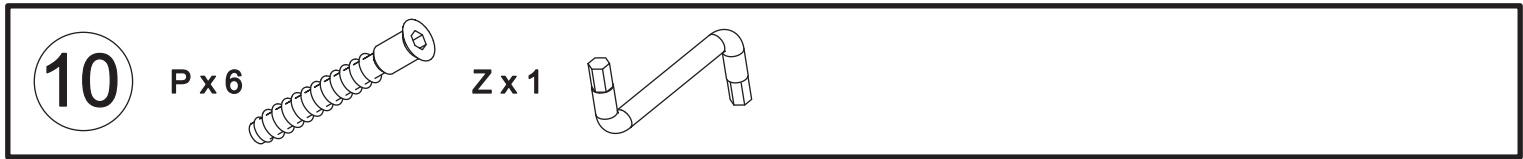
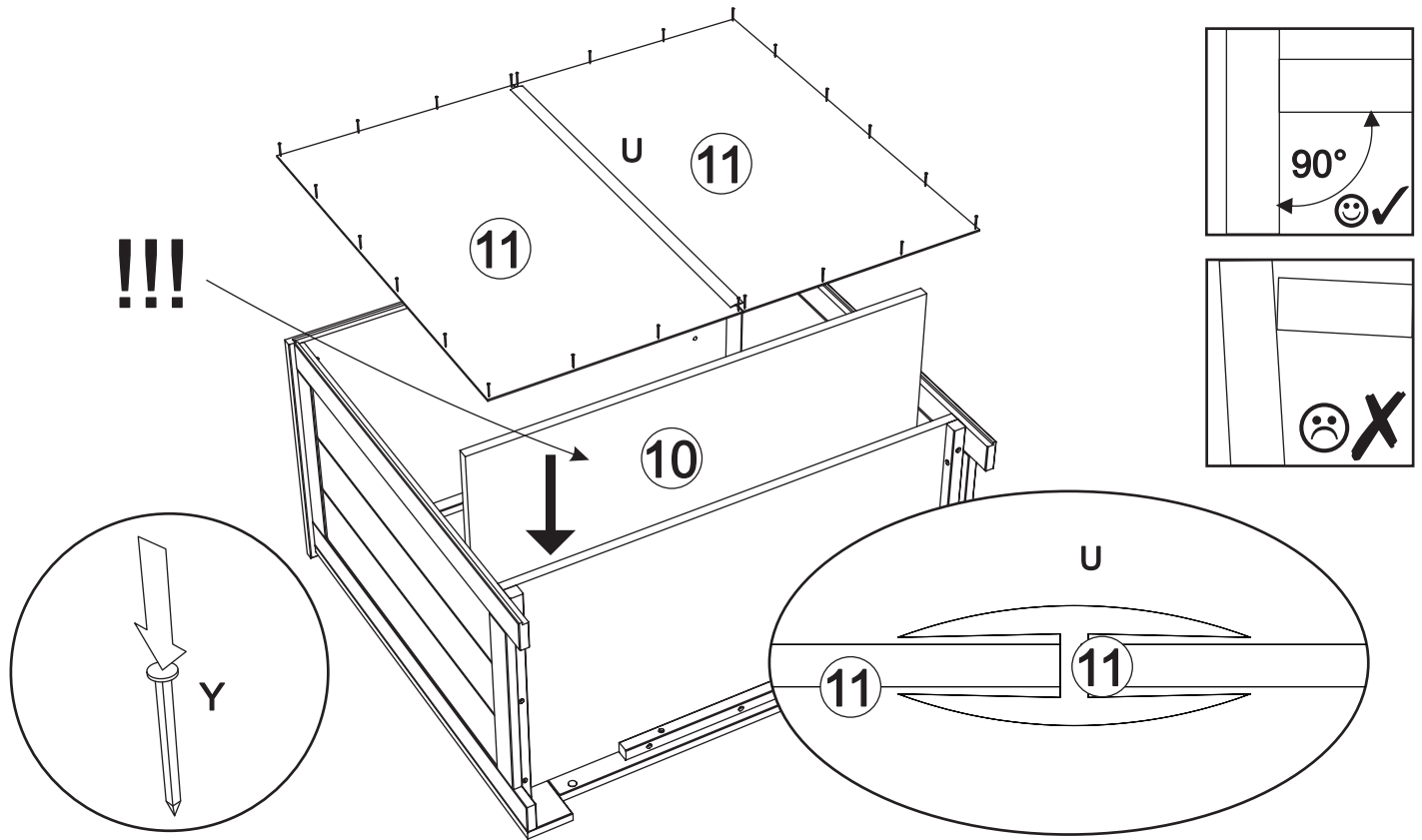
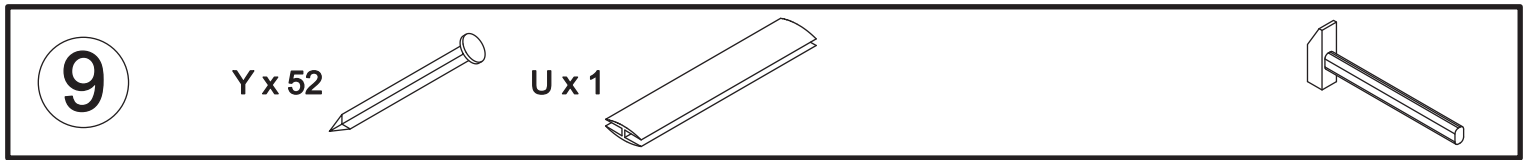

Wenn Sie Haben Wickeltisch art.2004

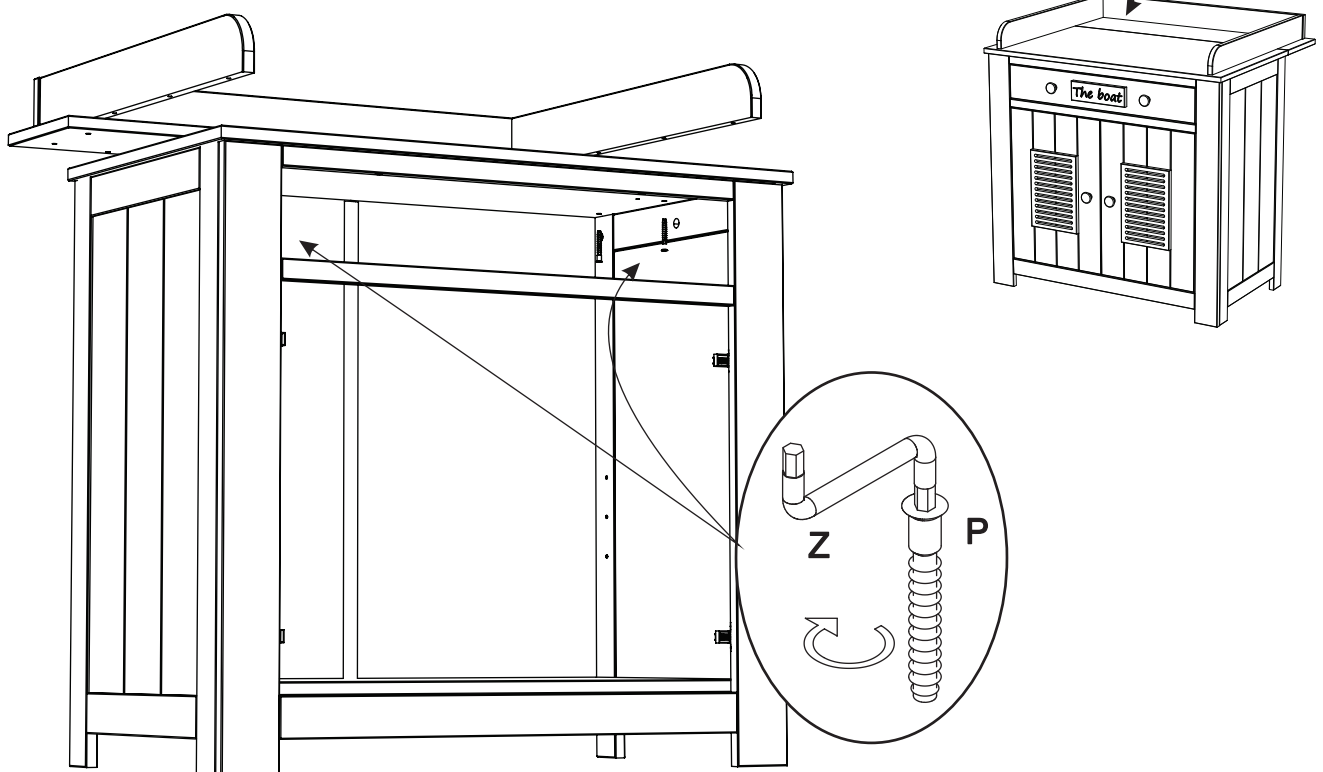

11

M x 4

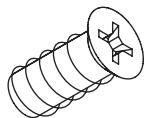

Q x 1

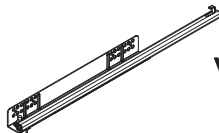

V x 1

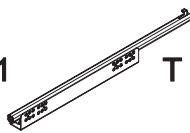

T x 2



J x 2

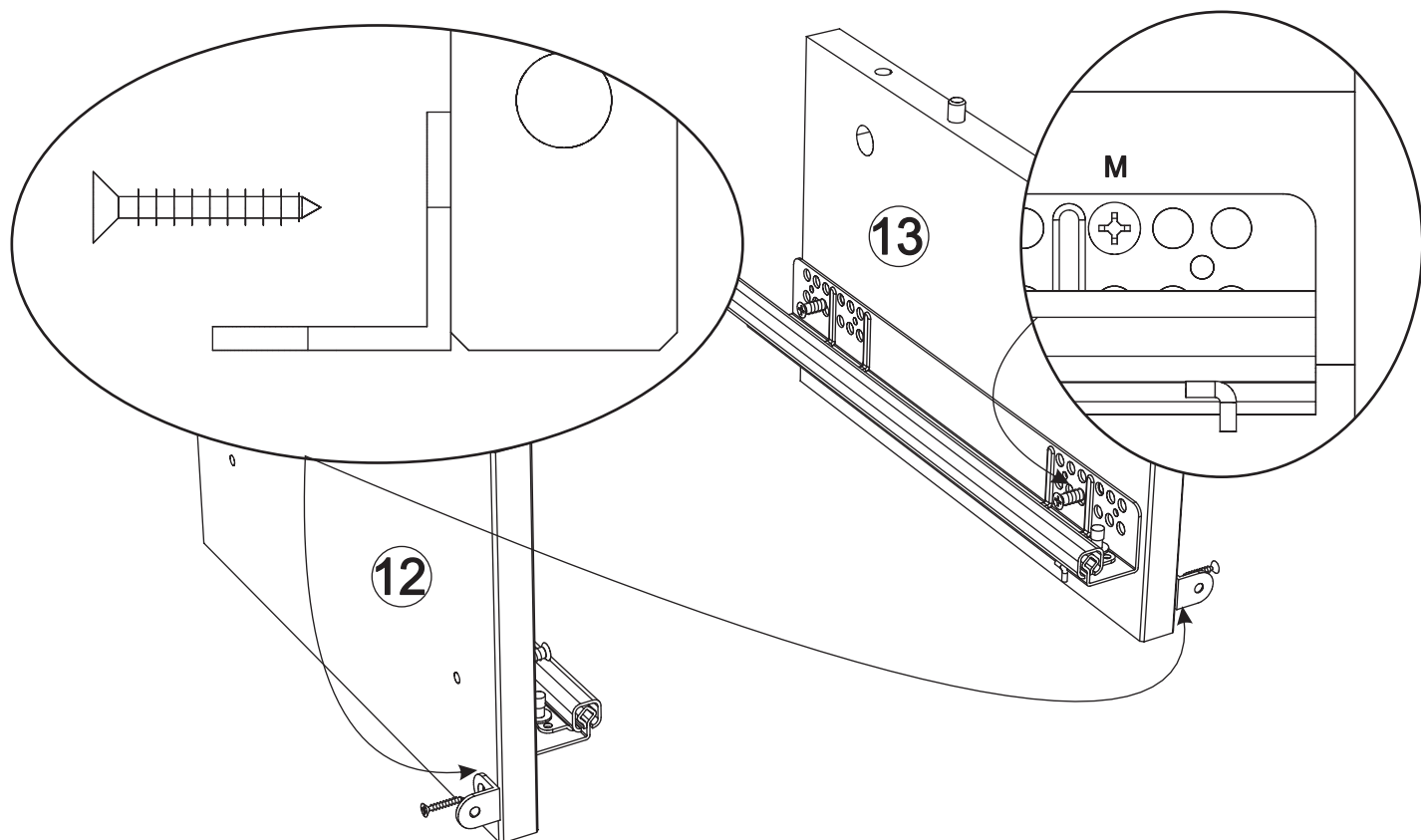
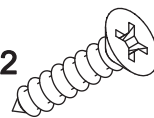

12

J x 2

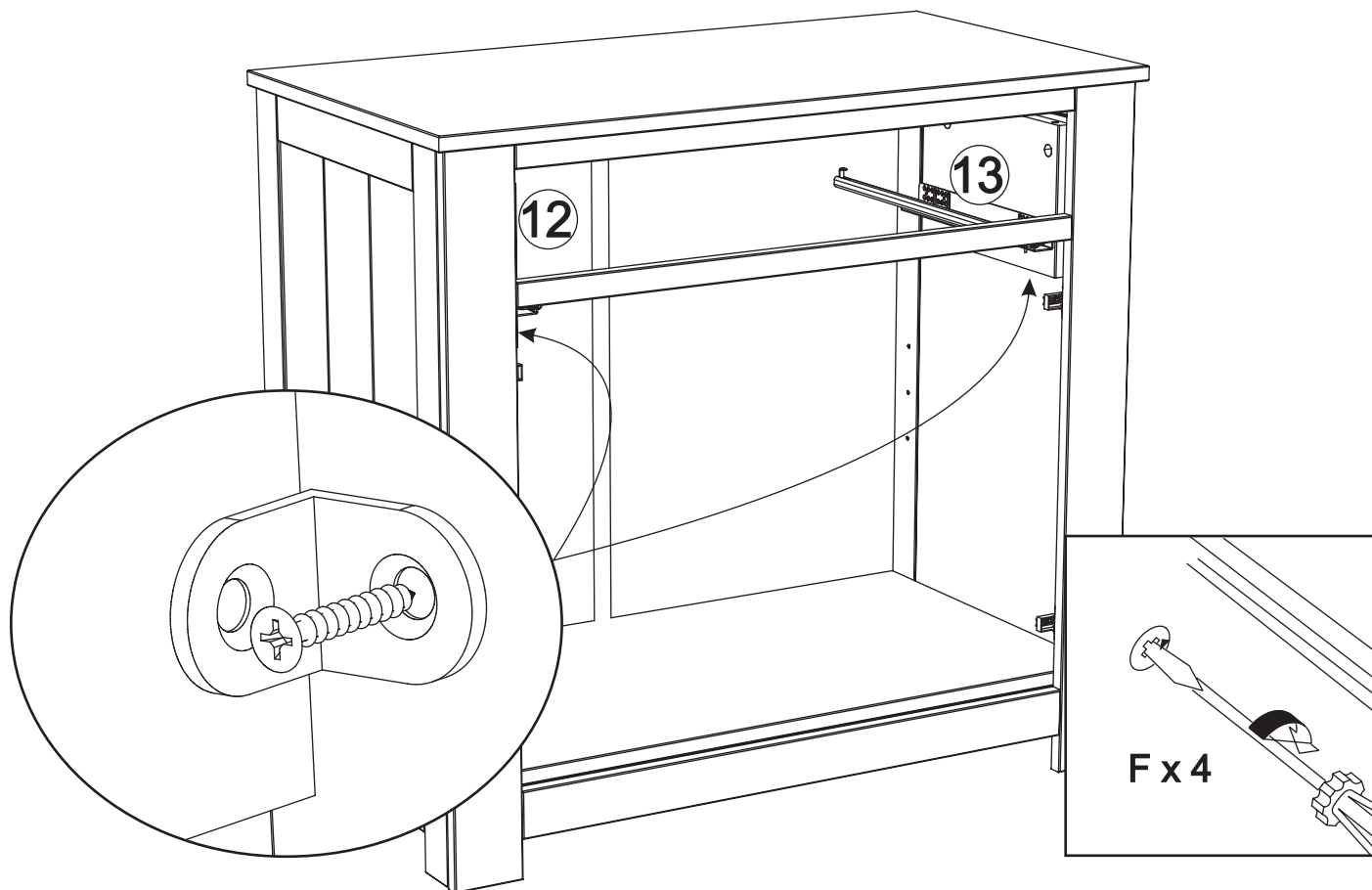
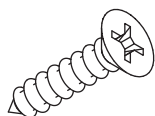

13

B x 2

E x 4

12 mm

↑

↓

D x 4

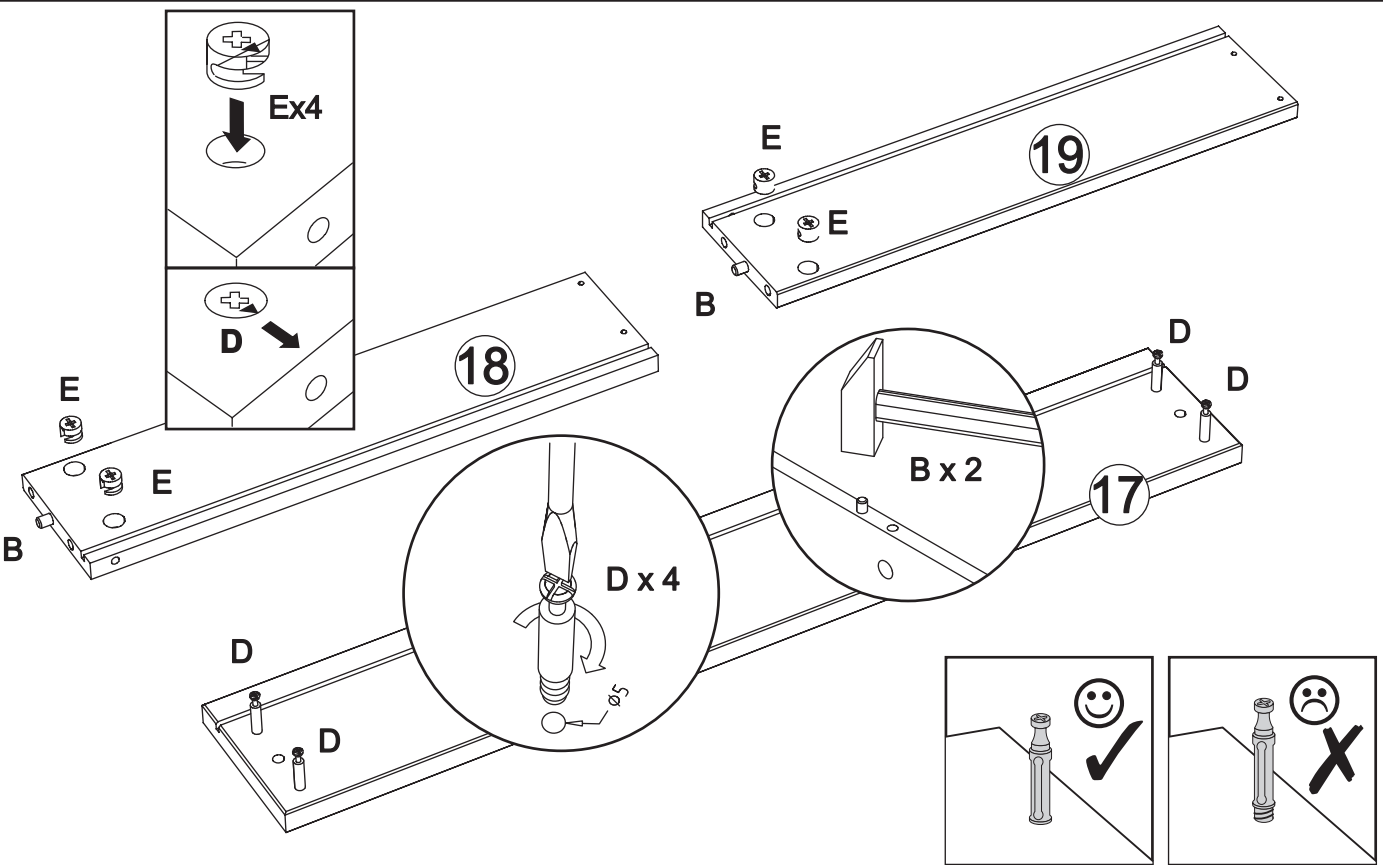

14

K x 4

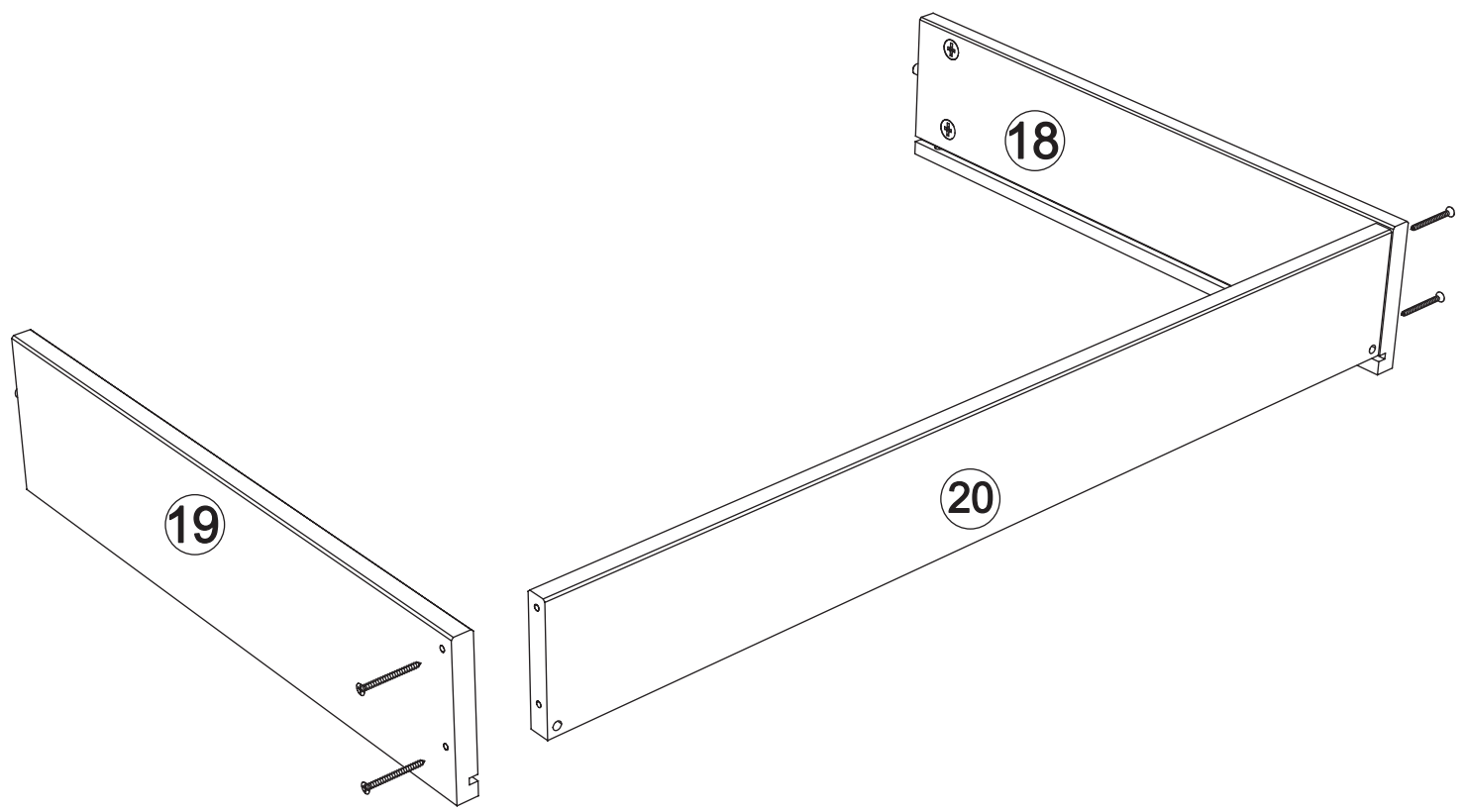

15

G x 4

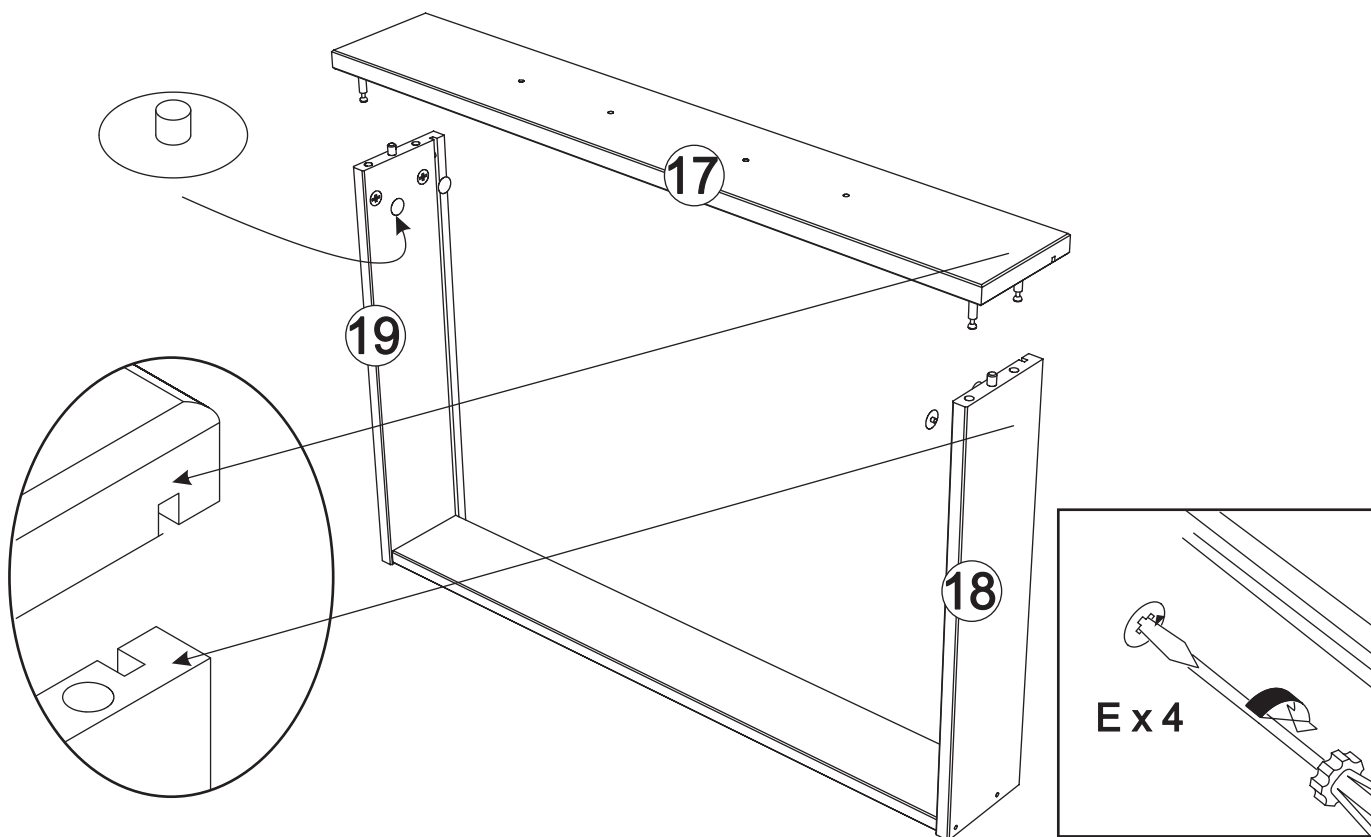
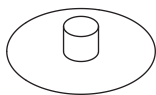

16

Y x 5

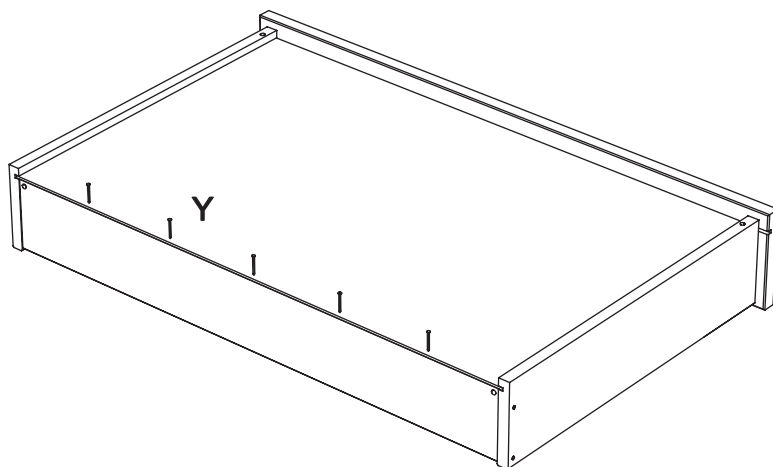
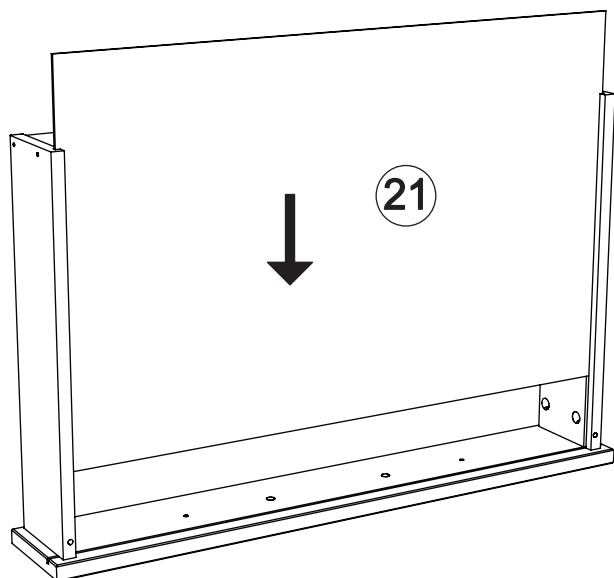
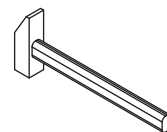
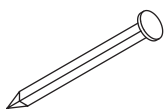

17

L x 2

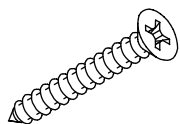

N x 2

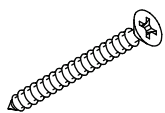

O x 2

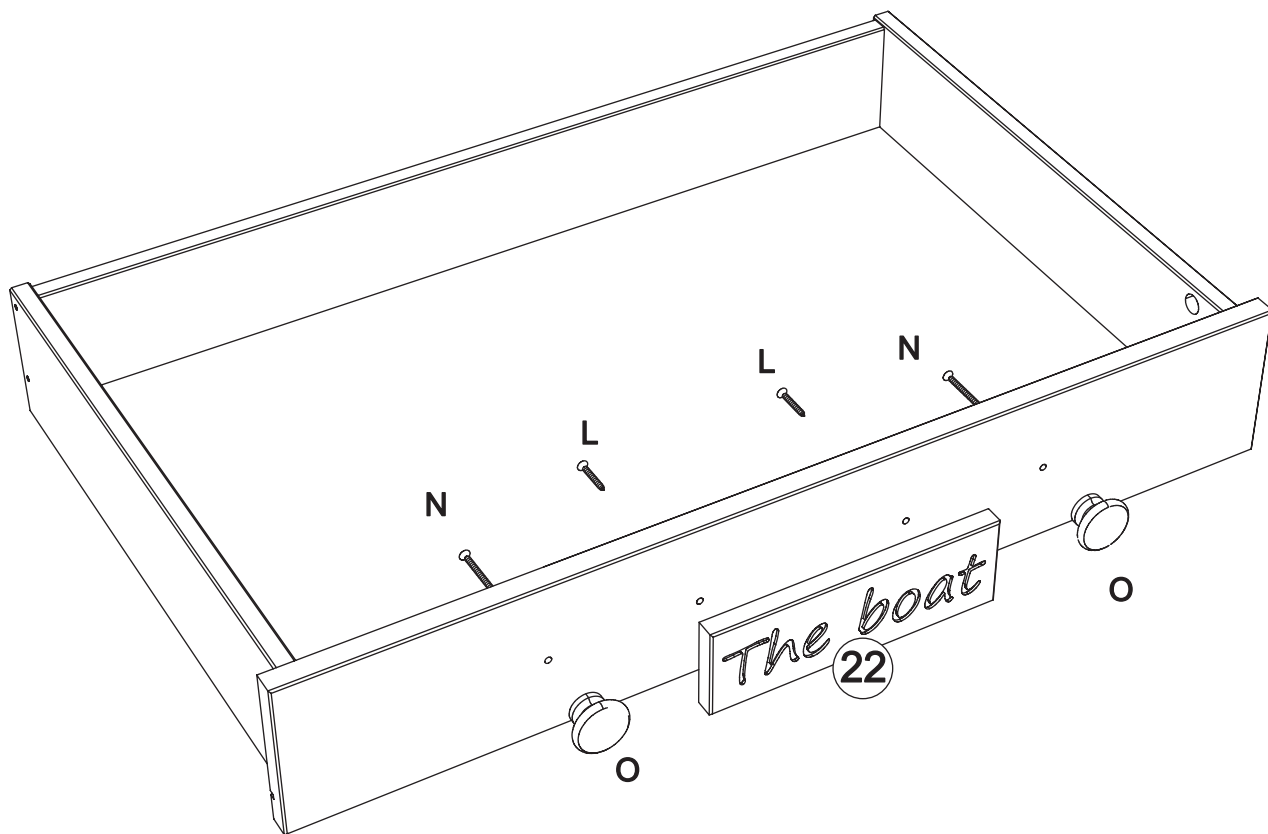
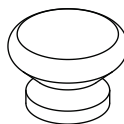

18



Hinteransicht
des Schubkastens



Einhängen
der Schublade

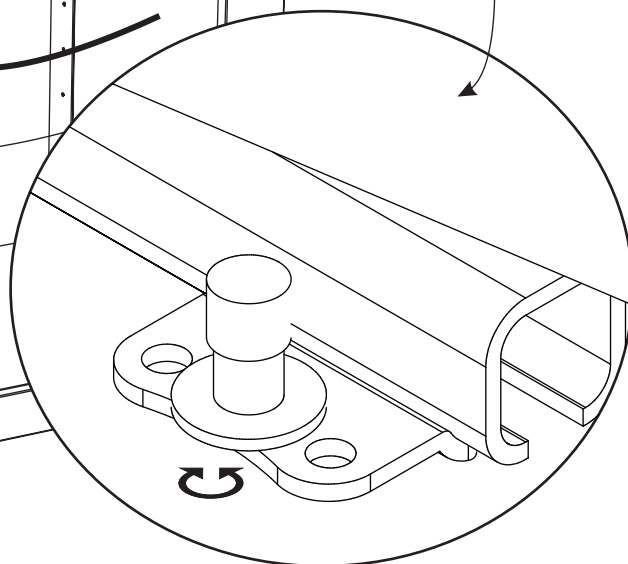
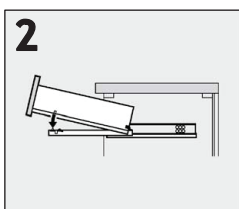
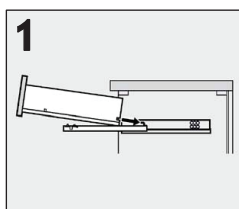

19

J x 8

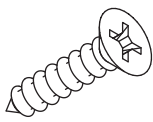

R x 4

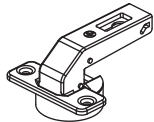

N x 2

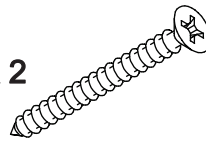

O x 2

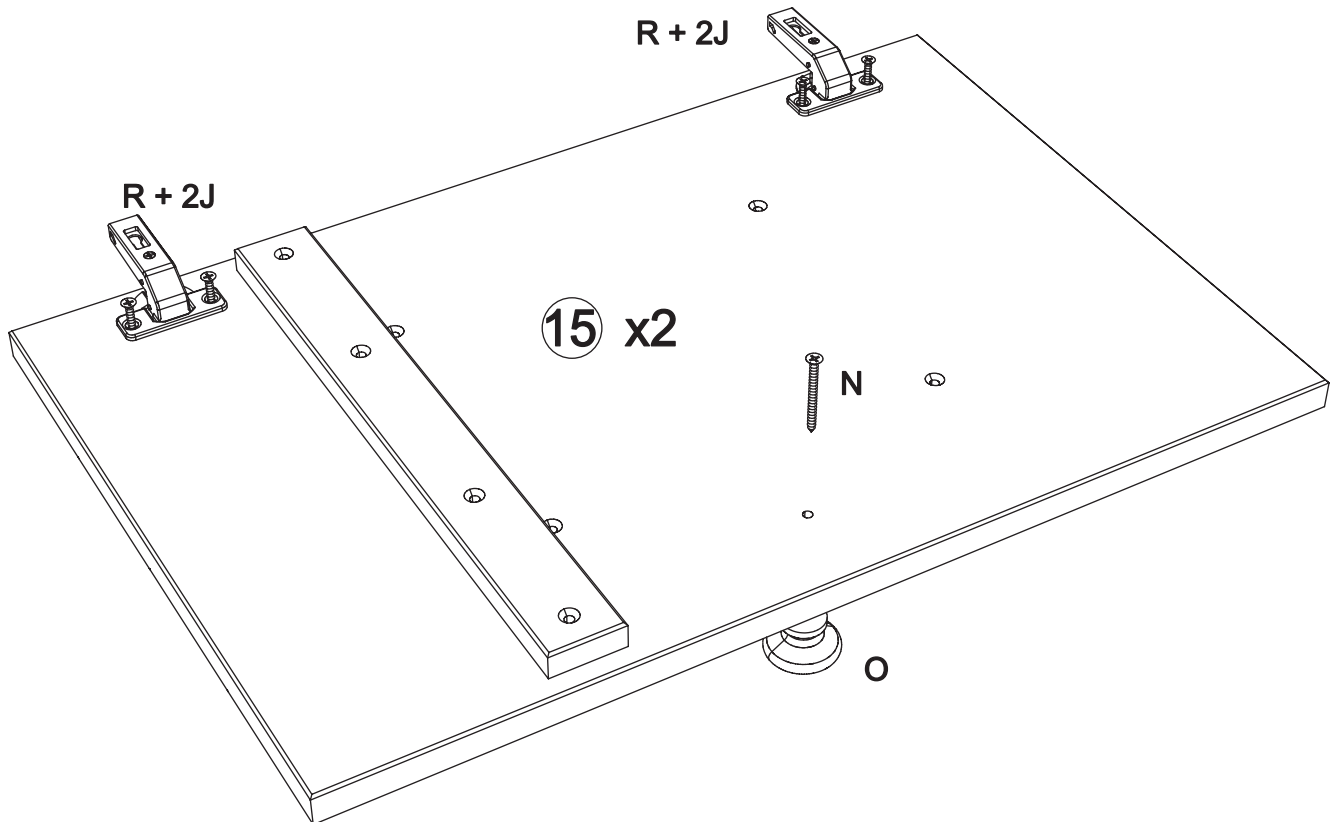
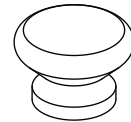

20

A x 8

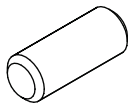

L x 8

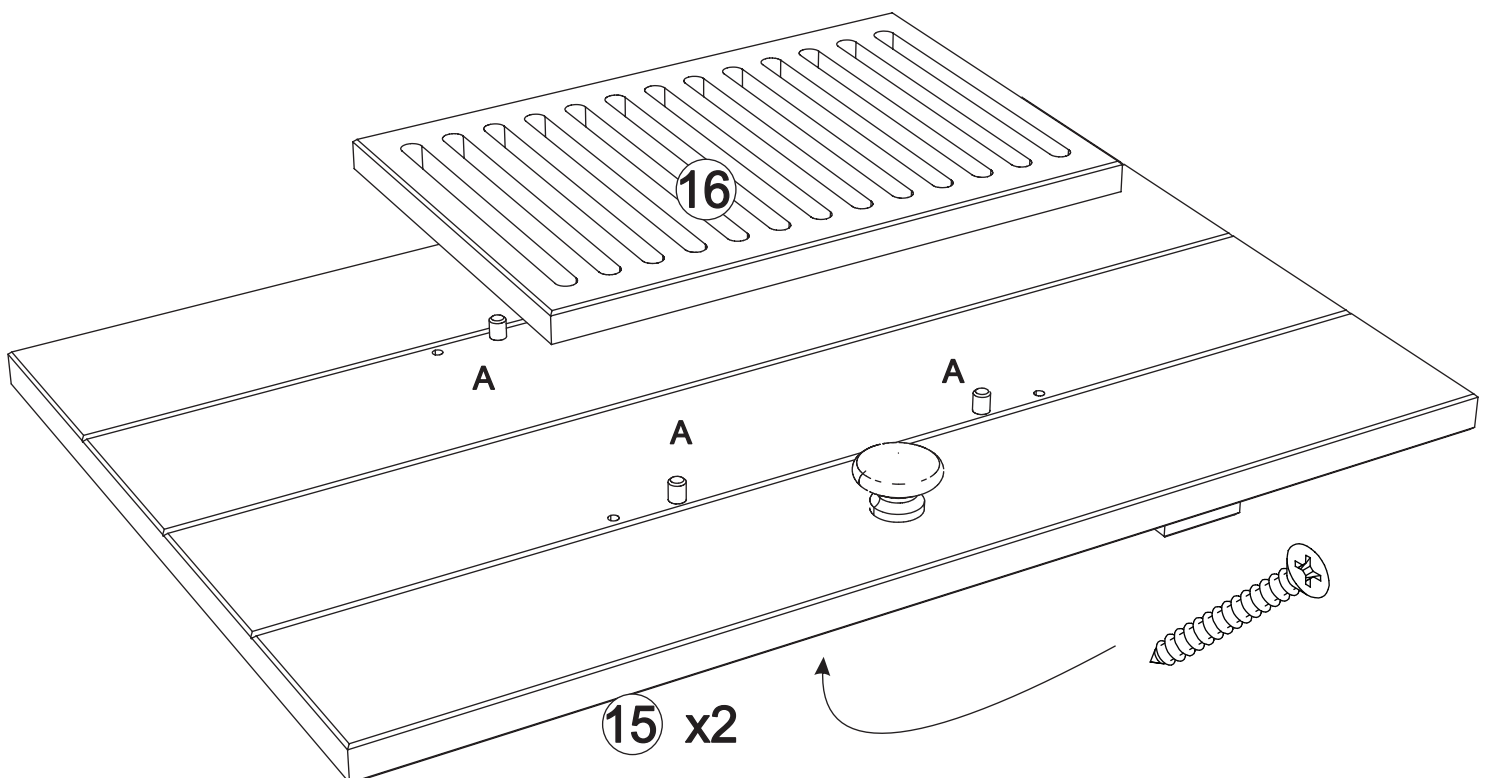
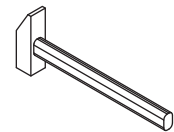
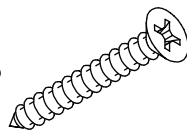

21

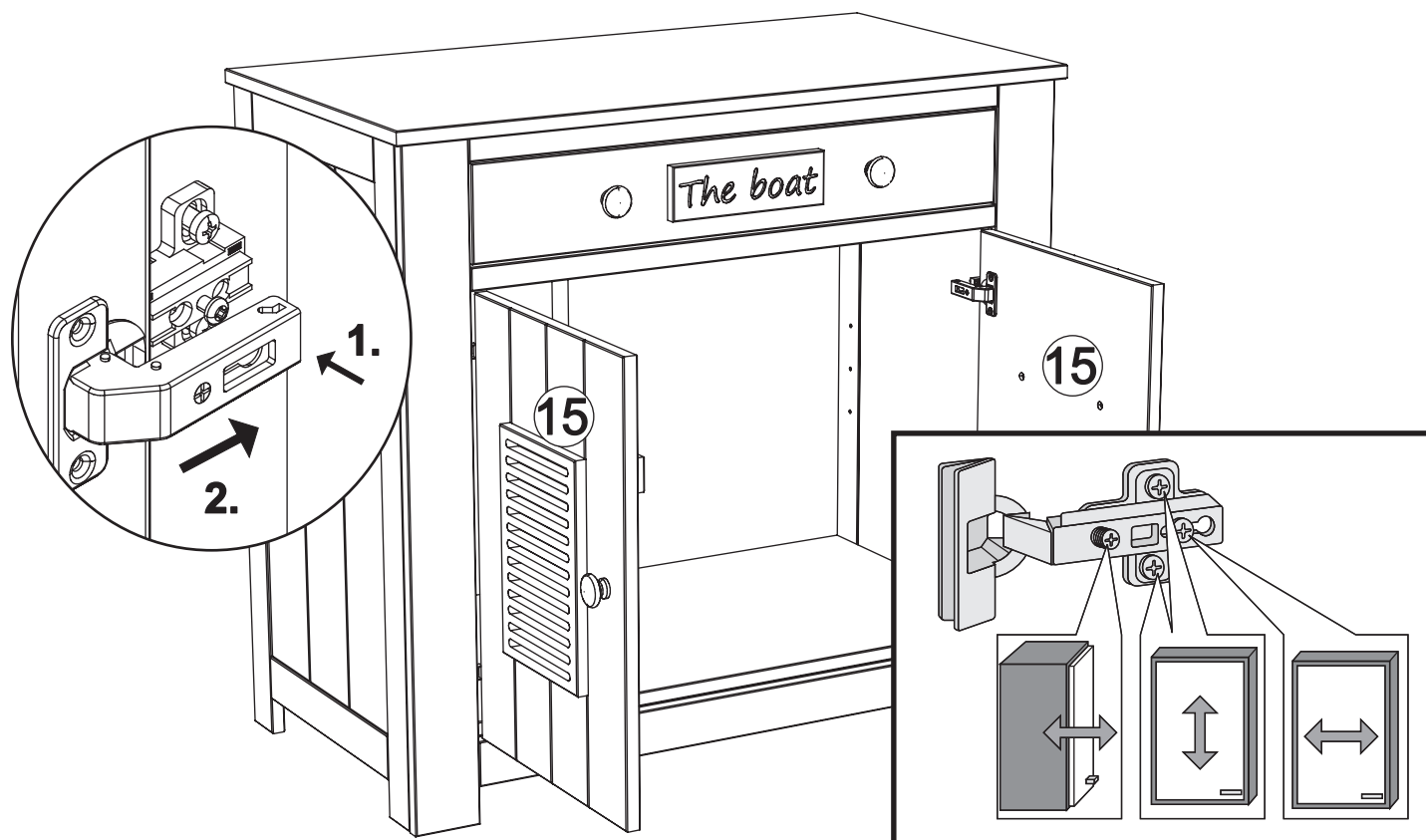

22

X x 8

